

For Town Planning Stamp

**TOWN & COUNTRY DEVELOPMENT**  
**PLANNING OFFICE**  
**APPROVED PLAN**

NUMBER 0849/05/2011D

DATE 2011-10-20

*[Signature]*  
**CHIEF TOWN PLANNER**

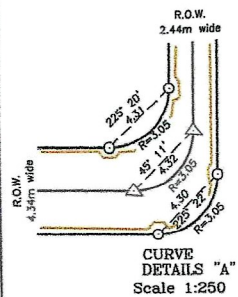

Drax Hall  
Plantation

- LEGEND**
- Denotes Iron Found
  - Denotes Iron Placed
  - △ Denotes Calculated Point

AREA SCHEDULE in sq.metres				
LOT No.	R.O.W. (brown)	Drainage Reserve (blue)	Land (green)	Total
128A	79.5	64.4	891.6	1035.5
128B	74.8	142.9	1277.6	1495.3
128C	----	240.8	890.4	1131.2
<b>TOTAL</b>	<b>154.3</b>	<b>448.1</b>	<b>3059.6</b>	<b>3662.0</b>

Other Land of Drax Hall Plantation

**NOTE WELL**  
 LOTS 128A, 128B AND 128C WILL HAVE RIGHT OF ACCESS  
 OVER THE RIGHT-OF-WAY

**NOTES**  
 REFERRED TO:  
 Master Plan of Drax Hall Tenantry done by Vincent Alleyne  
 certified June 30th, 1983 (DLS 1134/85)

## BARBADOS

PLAN OF SUBDIVISION OF LAND BORDERED GREEN, BROWN & BLUE  
 SITUATED AT LOT 128, DRAX HALL TENANTRY ST. GEORGE

Containing: 154.3 sq. metres (in right-of-way bordered brown)  
 448.1 sq. metres (in drainage reserve bordered blue)  
 3059.6 sq. metres (in land bordered green)

**TOTAL 3662.0 sq. metres (or 39403.1 sq. ft)**

Surveyed For: **KERRY MOTTLEY AND GREGSTON BELGRAVE**

Certified this 8th day of September 2011

*[Signature]*  
 Harrell (Jackie) Gaslin, Land Surveyor

**SCALE 1:500**

Distances are in metres

Bearings are Grid and originated from plan  
 1134/85 by Vincent Alleyne certified  
 June 30th, 1983

For Use by Lands and Surveys Department

*[Signature]*  
 10/10/2011